



PRINCIPAL PARTICULARS

Built	1983
Builder	Yokohama Yacht Co, Japan
Flag	Bahrain
Class	ABS
Class No.	8300486
Official No.	BN8250
Call Sign	A9D2793
GRT	50
NRT	45
Crew	6
Passengers	16

Barhain Cost Guard Approval:

Crew	6
Passengers	16

MACHINERY

Main Engines	2x GM 8V71
Power	1180 hp
Generators	2x Dieselite 22Kva/17.6Kw, 50Hz, 3Ph
Propellers	2
Rudders	Twin Coupled Flat Blade

DECK EQUIPMENT

Anchors	1x 9.4m/min
Anchor Windlass	1x 90Kg with 190m / 16mm

PRINCIPAL DIMENSIONS

Length (m) LOA	20.50
Breadth (m)	5.00
Depth (m)	2.50
Max. Draft (m)	1.20

CARGO CAPACITIES

Fuel Oil (USG)	1000
Potable Water (USG)	544
Ballast Water (USG)	113
Deck Cargo (T)	15
Deck Area (m ²)	40
Deck Strength (T/m ²)	2.5

SPEED & CONSUMPTION

Max. Speed (Knots)	17
Daily Consumption (T)	2.5 max
Fuel Type	Marine Gas Oil

NAVIGATION EQUIPMENT

GPS	1x Koden
Radar	1x Furuno
Echo Sounder	1x Raymarine
VHF Radio	2x Sailor
SSB Radio	1x JRC
Magnetic Compass	1x ICS



GENERAL ARRANGEMENT PLAN - RAVEN

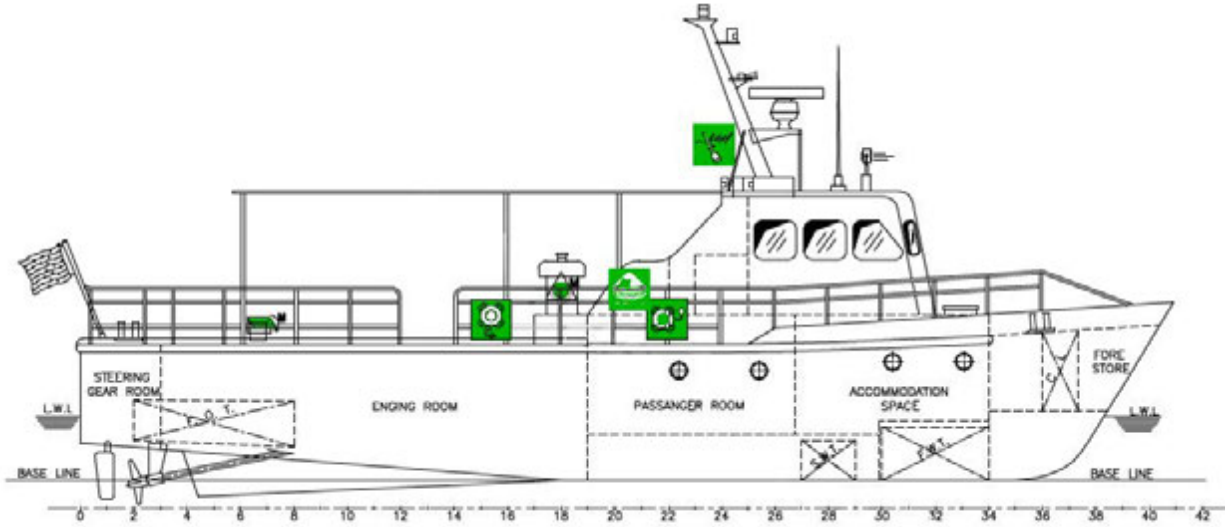

SIDE VIEW

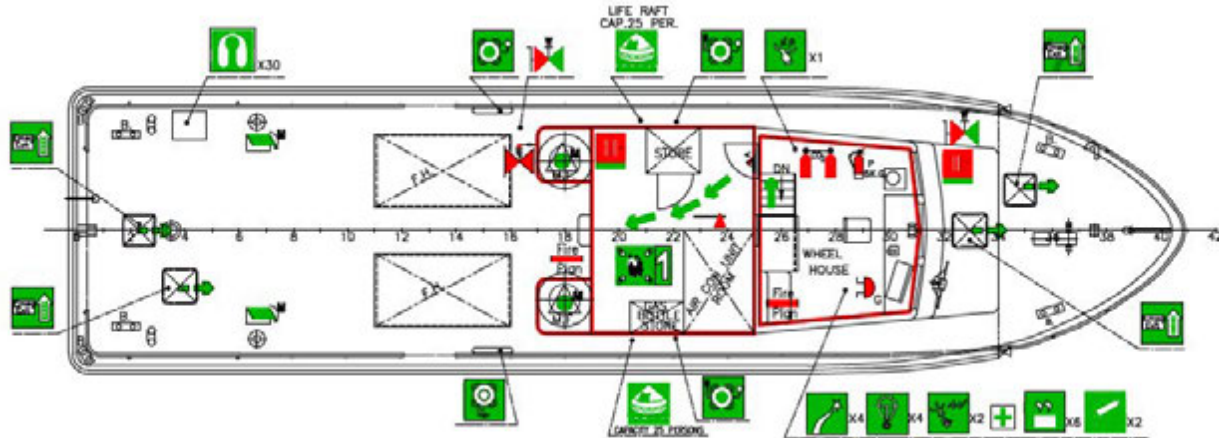

MAIN DECK VIEW

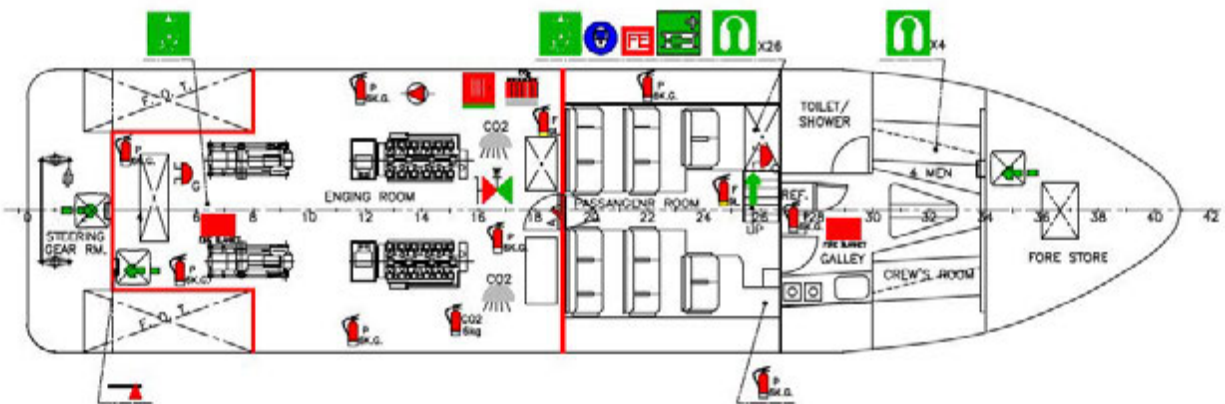

BELOW MAIN DECK VIEW