



# SEA MAJESTIC

## TOWING TUG



### PRINCIPAL PARTICULARS

Built	2006
Builder	Forward Marine Enterprise SDN BHD Malaysia
Flag	Bahrain
Class	GL
Class No.	107413
Official No.	BN 5006
IMO No.	9419046
Call Sign	A9HS
GRT	298
NRT	90
Bollard Pull (T)	40

### MACHINERY

Main Engines	Mitsubishi S12R-MPTK
Power	2x 1500 hp @ 1650 rpm
Generators	2x Cummins Diesel 78Kw 415/230 Volts
Propellers	2x Manganese/Bronze
Rudders	2
Oily/Water Sep.	1x DFCS-0.25m <sup>3</sup> /Hr
Sewage Treatment	WCH-0.5 15-25 Persons

### DECK EQUIPMENT

Anchor Windlass	3T Hydr
Anchors	2x570 Kg
Towing Winch	Single Drum 30T
Tugger Winch	5T
Complement	15 Persons

### SURVIVAL EQUIPMENT

2x 20 Men Liferaft 20x Life Jackets

### PRINCIPAL DIMENSIONS

Length (m) LOA/LBP	32.10 / 29.39
Breadth (m)	9.00
Depth (m)	4.20
Max. Draft (m)	3.50

### CARGO CAPACITIES

Diesel Fuel Oil (T)	173
Potable Water (T)	46
Ballast (T)	31
Lub Oil Tank (T)	2

### SPEED & CONSUMPTION

Max. Speed (Knots)	12
Daily Consumption (T)	6.0
Fuel Type	MDO

### NAVIGATION EQUIPMENT

Furuno SSB	FS-1570
Furuno Immersat-C	Felcom-15
Furuno GPS	GP-32
Furuno RADAR	1832
Furuno NAVTEX	NX-700B
Furuno VHF GMDSS	FM-8800S
Sanyung EPIRB	SEP-406
Compass	Diako SR-150 PK
ICOM 2 Way Wakie Talkie	GM-1600
Furuno ECHO SOUNDER	FCV-620



## GENERAL ARRANGEMENT PLAN - SEA MAJESTIC

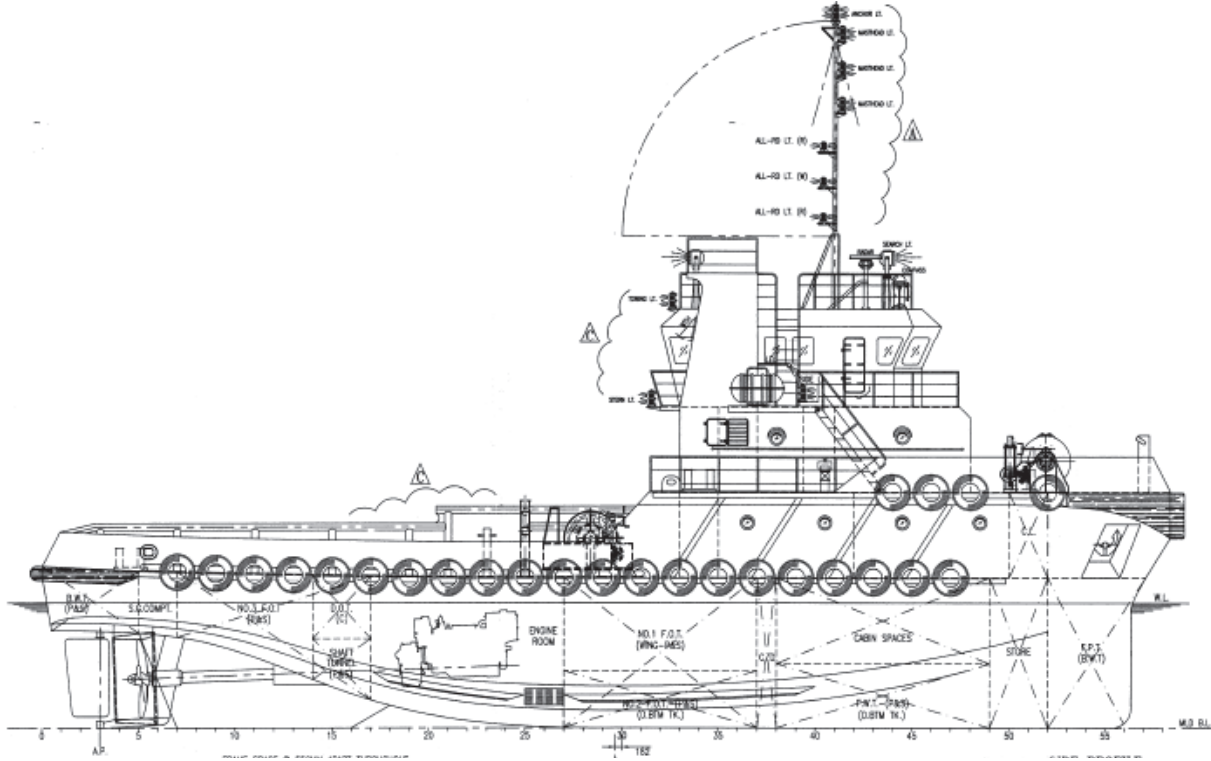

**SIDE VIEW**

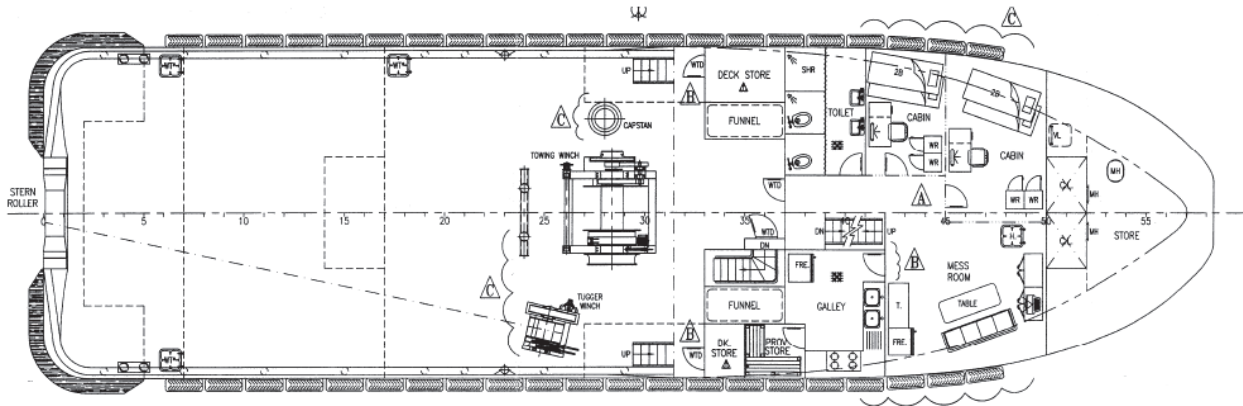

**TOP VIEW DECK LEVEL**